

# Mounting Instructions

**NOTE:** First turn off electricity.

## Surface Ceiling & Wall Mounting

1. Attach crossbar to junction box.
2. Use a flat head screwdriver to open front cover to connect the battery.
3. The color of the LEDs can be changed if needed (See UNIVERSAL RED AND GREEN COLOR).

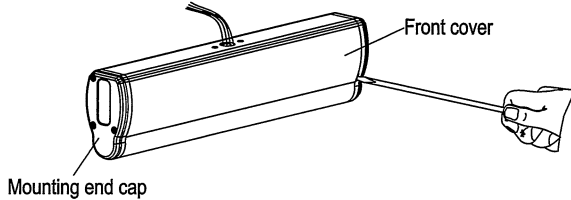

4. Feed AC supply wires through canopy center hole.
5. Assemble canopy onto main body assembly with (2) PM4\*12 screws(supplied) and make proper wire connections. (See ELECTRICAL CONNECTIONS).
6. Use (2) PM4\*40 screws (supplied) tighten canopy to crossbar.

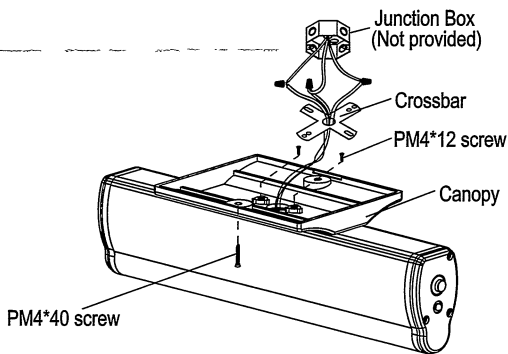

7. Insert EXIT faceplate to the bottom of the housing. If EXIT panel is for single face, make sure the word EXIT reads correctly.

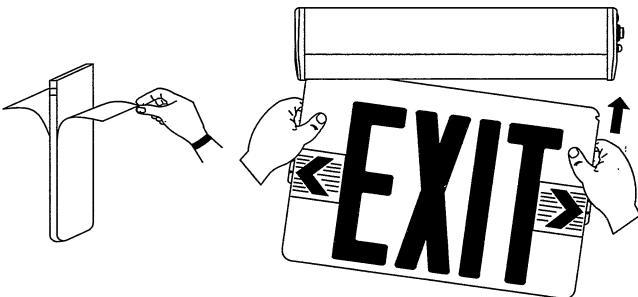

8. Determine direction for chevron placement. (See DETERMINE DIRECTION)

9. The ELRT-U can be installed on any surface, the sign is designed to rotate to any angle from 0° to 180°. To wall mount the exit sign, panel must be rotated at least 90°.

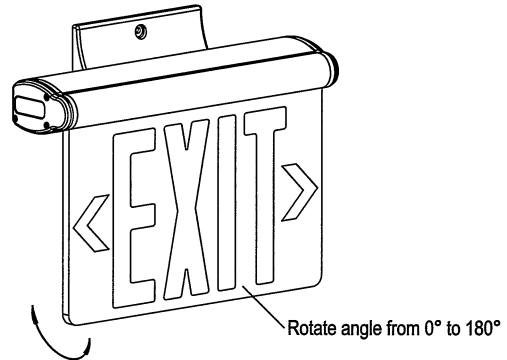

## Surface End Mounting

1. Attach crossbar to junction box.
2. Use a flat head screwdriver to open front cover to connect battery.
3. The color of the LEDs can be changed if needed (See UNIVERSAL RED AND GREEN COLOR ).
4. Remove the side cover.
5. Pull out all AC supply wires and feed wires through the center of both housing and mounting bracket.
6. Reference 5 - 9 step in surface ceiling & wall mounting above for surface end mounting.

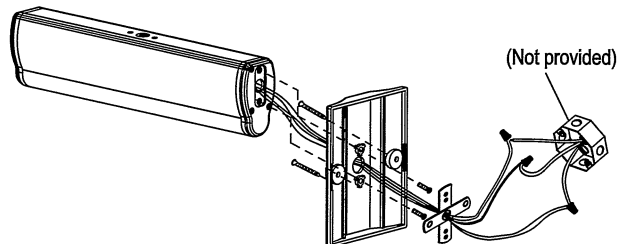

## MAINTENANCE

If the product remains in stock for over 9 months, the battery needs to be recharged; refer to the "BATTERY STOCK AND RECHARGE GUIDELINE" in the detailed manual. Regular testing of the equipment should be conducted in accordance with local codes. Replace batteries if their discharge time does not reach 90 minutes.

## OPERATION

Press the test button; the unit will illuminate via battery backup, and the LED indicator will turn off. Release the test switch to turn the LED indicator back on.

## TROUBLESHOOTING GUIDE

If the LED indicator fail to illuminate, perform the following checks:

1. Verify the AC supply; ensure the unit has a continuous 24-hour AC supply.
2. Check battery connections.
3. Discharge the battery and charge it for 24 hours, then retest.
4. If the above troubleshooting steps do not resolve the issue, contact the factory for assistance.

# INSTALLATION & OPERATION INSTRUCTIONS

Edge Lit LED Exit Sign | Surface Mount | Adjustable Angle | Red/Green Universal - ELRT-U

## Package Contents

Part	Description	Quantity
1	LED Edge-Lit EXIT Sign	1
2	Canopy	1
3	Hardware Bag	1

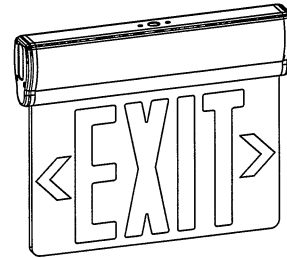

## Warnings and Cautions

### IMPORTANT SAFEGUARDS

## READ AND FOLLOW ALL SAFETY INSTRUCTIONS.

When using electrical equipment, basic safety precautions should always be followed including the following

1. Before starting the installation process, ensure to disconnect the power source by either switching off the circuit breaker or removing the relevant fuse from the fuse box. Relying solely on the light switch to cut off power is insufficient for preventing electrical shock.
2. Refrain from using the equipment outdoors.
3. Avoid mounting the equipment in proximity to gas or electric heaters.
4. Exercise caution when handling batteries. Battery acid can cause burns to the skin and eyes. In case of acid contact with skin or eyes, immediately flush with fresh water and seek medical attention.
5. Install equipment in locations and at heights where it is inaccessible to unauthorized individuals for tampering.
6. Using accessory equipment not endorsed by the manufacturer may lead to hazardous situations.
7. Only employ the equipment for its designated purpose.
8. All servicing tasks should be carried out exclusively by qualified personnel.
9. Allow the battery to charge for 24 hours before initial use.
10. Refrain from using alcohol or other detergents to clean or touch the chevrons.

## SAVE THESE INSTRUCTIONS

### ELECTRICAL CONNECTIONS

- Ensure correct connection of the supply wires.
- When utilizing 120VAC, connect the black and white wires to the building power source
- If utilizing 277VAC, connect the orange and white wires to the building power supply.
- For any unused wires, cap them off securely. In all scenarios, utilize standard wire nuts for wire connections.

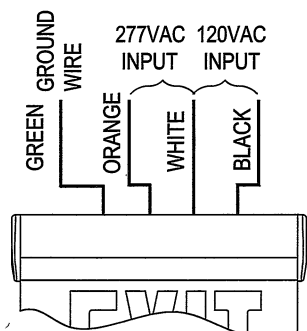

### DETERMINE DIRECTION

- If a directional arrow is required, keep the arrow(s) and remove the instruction film.
- If no arrow(s) are needed, remove both the indicator and instruction film all together.



### UNIVERSAL RED AND GREEN COLOR

1. The ELRT-U is switched to RED from factory
2. Slide the switch from left to right to change colors from Red to Green and vice versa.

