

INSTALLATION & OPERATION INSTRUCTIONS

LED SWINGING EXIT SIGN | VANDAL RESISTANT

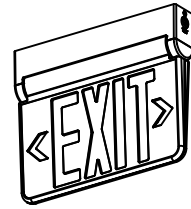

IMPORTANT SAFEGUARDS

READ AND FOLLOW ALL SAFETY INSTRUCTIONS

When using electrical, basic safety precautions should always be followed including the following.

1. Disconnect power at fuse or circuit breaker before installing or servicing.
2. Do not use outdoors.
3. Do not mount in hazardous locations, or near gas or electric heaters.
4. Do not let power cords touch hot surface.
5. Equipment should be mounted in locations and at heights where it will not be subjected to tampering by unauthorized personnel.
6. Do not use this equipment for other than intended use.
7. All servicing should be performed by a qualified personnel only.
8. After installation is finished, please charge battery for 24 hours.

SAVE THESE INSTRUCTIONS

MAINTENANCE

Battery will require a charge period if product keep in storage over 12 months, detail manual refer "BATTERY STOCK AND RECHARGE GUIDELINE". We recommend that the equipment be tested regularly in accordance with local codes. Replace the batteries as needed if discharge time does not achieve 90 minutes.

OPERATION

Press the test button, unit will be illuminated by battery backup and the LED indicator will be turned off. Release the test switch, LED indicator will be turned on.

TROUBLE SHOOTING GUIDE

If LED array or LED indicator does not illuminate, check the following:

1. Check AC supply - Verify that the unit has constant 24-hour AC supply.
2. Battery connection, verify the battery is connected properly.
3. Discharge battery and charge for 24-hour and then retest.
4. If the above troubleshooting does not solve the problem, please contact the factory for assistance.

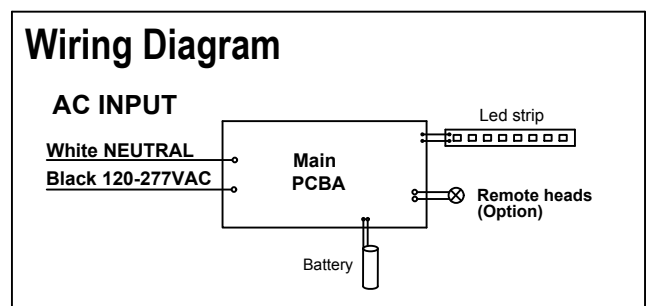
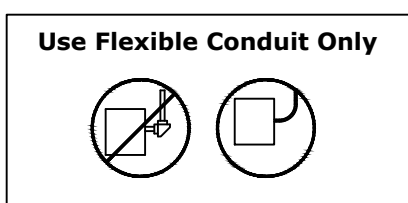

NOTE: First turn off electricity.

Surface Ceiling & Wall Mounting

1. Attach the crossbar to the junction box(TM8#-32*-1).
2. Remove fixing screw by philips screw driver, then remove the mounting bracket, connect battery connector on PCBA.

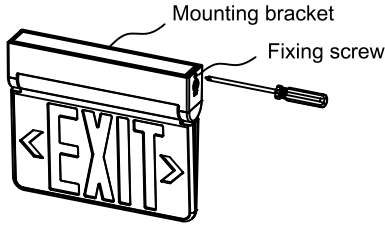

3. Knockout mounting and cable entry holes on the top of mounting bracket.
4. Assemble canopy onto mounting bracket with 2 screws and nuts.
5. Feed AC wires through out the cable hole of mounting bracket. make proper wire connections (Refer to Wiring diagram).
6. Use (2) PM4-40 screws (supplied) tighten canopy to crossbar.

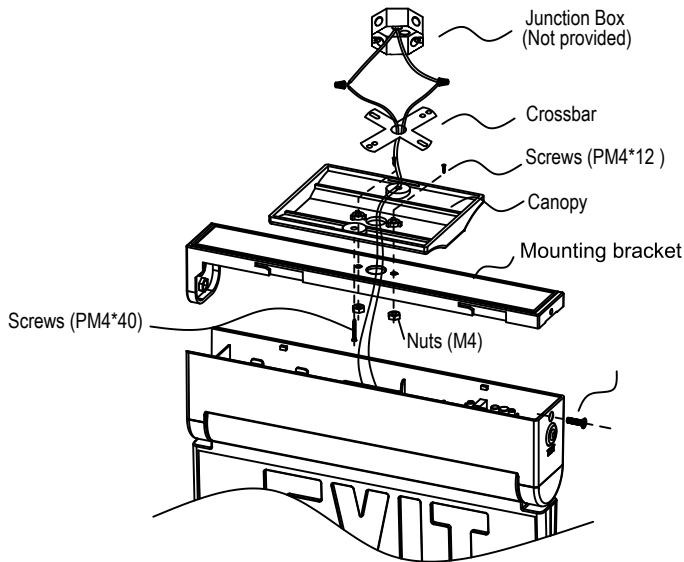

7. Assemble housing on the mounting bracket, slide up first then slide to the left, then restore the fixing screw.

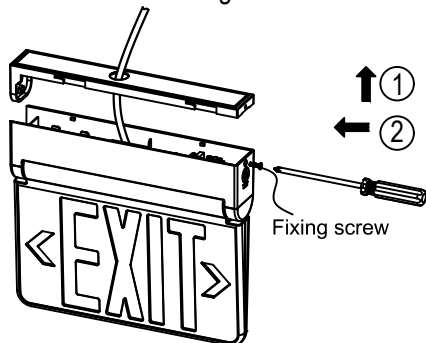

8. Snap chevron plug on the exit plate if required.

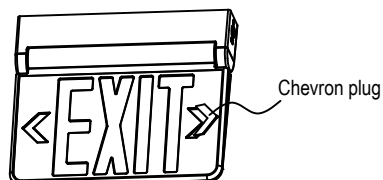

9. If the fixture needs to be single-faced, assemble the back plate onto the fixture.

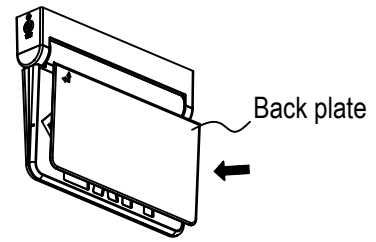

10. The exit panel is rotational, suitable for different angles of mounting surface.

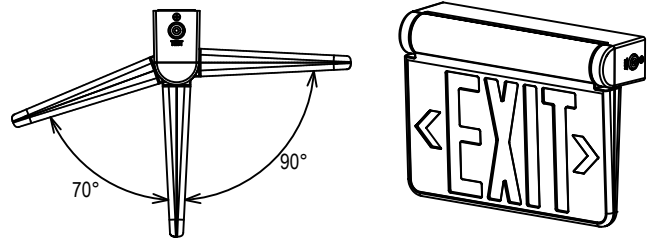

Side Mounting

1. Attach the crossbar to the junction box(TM8#-32*-1).
2. Remove fixing screw by philips screw driver, then remove the mounting bracket, connect battery connector on PCBA.
3. Knockout mounting and cable entry holes on the side of mounting bracket.
4. Feed AC wires through out the side cable hole of mounting bracket, make proper wire connections (Refer to Wiring diagram).
5. Reference 6 - 9 steps in surface ceiling & wall mounting above for side mounting.

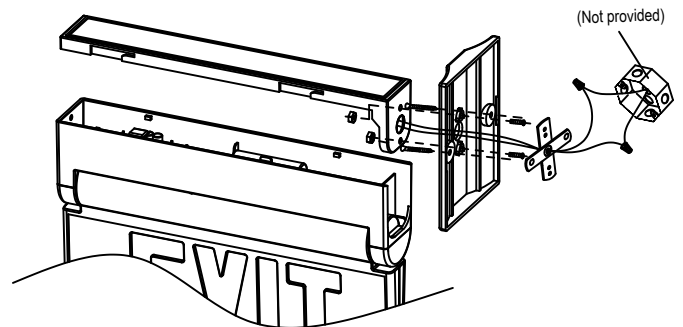

Connecting Remote Heads

Optional function, only RC item with remote capability. maximum remote capability 6V1.5W

Attach remote wire on remote connector on PCBA, Connect remote heads extended wire to remote wire, yellow is positive(+), purple is negative(-). connect wires using wire nuts.

